

Upper Saddle River 5K Upper Saddle River, New Jersey

NJ17539JHP

Effective Aug 25, 2017 to Dec 31, 2027



All directions are given relative to the running direction.

All roads have unrestricted access.

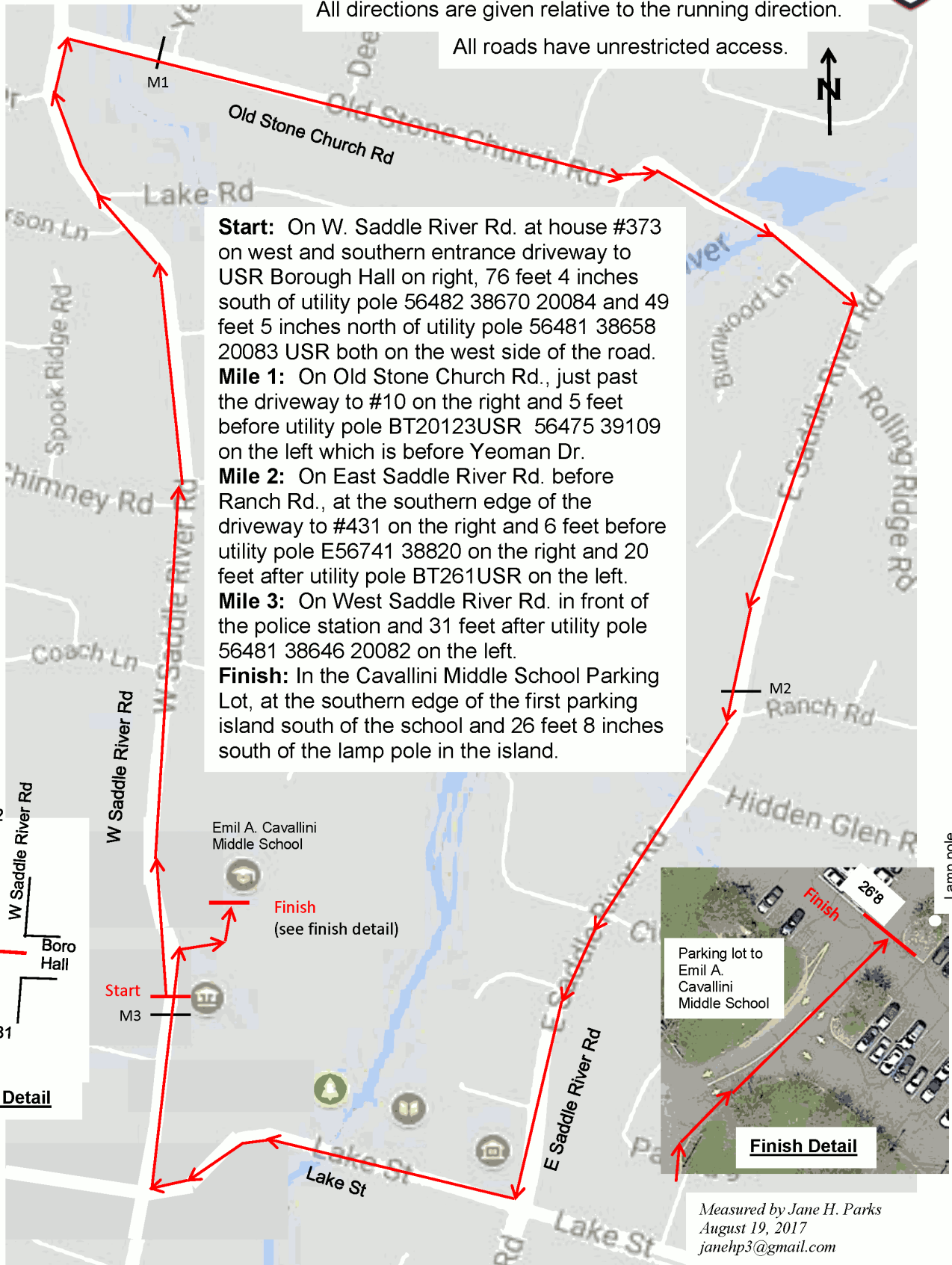

Start: On W. Saddle River Rd. at house #373 on west and southern entrance driveway to USR Borough Hall on right, 76 feet 4 inches south of utility pole 56482 38670 20084 and 49 feet 5 inches north of utility pole 56481 38658 20083 USR both on the west side of the road.

Mile 1: On Old Stone Church Rd., just past the driveway to #10 on the right and 5 feet before utility pole BT20123USR 56475 39109 on the left which is before Yeoman Dr.

Mile 2: On East Saddle River Rd. before Ranch Rd., at the southern edge of the driveway to #431 on the right and 6 feet before utility pole E56741 38820 on the right and 20 feet after utility pole BT261USR on the left.

Mile 3: On West Saddle River Rd. in front of the police station and 31 feet after utility pole 56481 38646 20082 on the left.

Finish: In the Cavallini Middle School Parking Lot, at the southern edge of the first parking island south of the school and 26 feet 8 inches south of the lamp pole in the island.

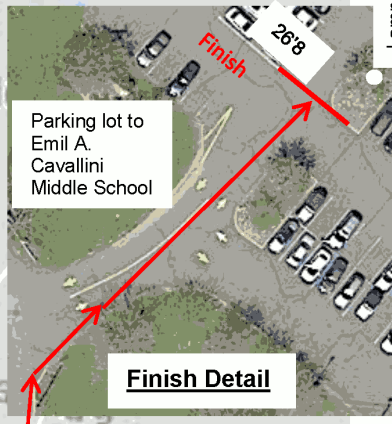
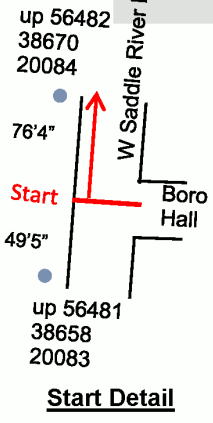

Measured by Jane H. Parks
 August 19, 2017
 janehp3@gmail.com



**Road Running Technical Council
USA Track & Field**

Measurement Certificate

recognized by



Name of the course Upper Saddle River 5K Distance 5 km
 Location (state) New Jersey (city) Upper Saddle River
 Type of course: road race calibration course
 Measuring method: bicycle steel tape electronic distance meter
 Measured by (name, address, phone & e-mail) Jane H. Parks IAAF/AIMS Grade A Measurer
973.349.0033, janehp3@gmail.com
 Race contact (name, address, phone & e-mail) Ervin Barry, barryervin@optonline.net, 201.327.7367
 Date(s) when course measured: August 19, 2017
 Number of measurements of entire course: 2 Course Configuration: Loop
 Elevation (meters above sea level) Start 69 Finish 71 Highest 94 Lowest 58
 Straight line distance between start & finish 128 meters Drop -0.4 m/km Separation 2.56 %
 Type of surface: paved 100 % dirt _____ % gravel _____ % grass _____ % track _____ %
 Effective date of certification: August 25, 2017 Certification code: NJ17539JHP

Notice to Race Director: Use this Certification Code
in *all* public announcements relating to your race.

Be It Officially Noted That

Based on examination of data provided by the above named measurer, the course described above and in the map attached is hereby certified as reasonably accurate in measurement according to the standards adopted by the Road Running Technical Council. If *any* changes are made to the course, this certification becomes void, and the course must then be recertified.

Verification of Course — In the event a National Open Record is set on this course, or at the discretion of USA Track & Field, a verification remeasurement may be required to be performed by a member of the Road Running Technical Council. If such a remeasurement shows the course to be short, then all pending records will be rejected and the course certification will be cancelled.

This certification expires on December 31 in the year 2027

AS NATIONALLY CERTIFIED BY:

Jane H. Parks

Date: August 25, 2017

Jane H. Parks – USATF/RRTC Certifier
973.349.0033 janehp3@gmail.com